

## Frequently Asked Questions

**Q. What are the proposals?**

A. The aim is to retain a strong and viable market, with new retail and leisure uses bringing additional quality operators, giving a new lease of life and enhancing the future vitality of Clitheroe town centre.

**Q. Why is this being proposed?**

A. A number of national retail and leisure brands have already identified Clitheroe as a desired location to accommodate their future expansion needs, and we need to plan for this. The economy of Clitheroe and the Ribble Valley is changing and many future challenges will need to be addressed in order to meet future demands, including the area's tourism and leisure growth, competition from other town centre and retail destinations throughout the region and increasing spend in the town centre.

**Q. How will this be paid for?**

A. Funding to deliver the £9 Million scheme will be from the private sector. It is not from the Council or public money that would otherwise have been spent on providing public services.

**Q. Will there be space on site for additional activities and events?**

A. Yes. The site is flexible and will allow space for a regular programme of events and festivals, including for example, the Clitheroe Food Festival.

**Q. How can I voice my views on the proposals?**

A. To ensure that we get the right scheme for Clitheroe, Ribble Valley Borough Council is undertaking a wide reaching engagement programme prior to detailed plans being brought forward for consideration. Surveys will be available at the council offices and online and will also be sent to town centre businesses, emailed out to citizens' panel members and a postal survey will be sent randomly to 2000 households. This will also be backed up with street interviews around the town centre.



View from Castle



Site Plan



Ground Floor Plan



First Floor Plan

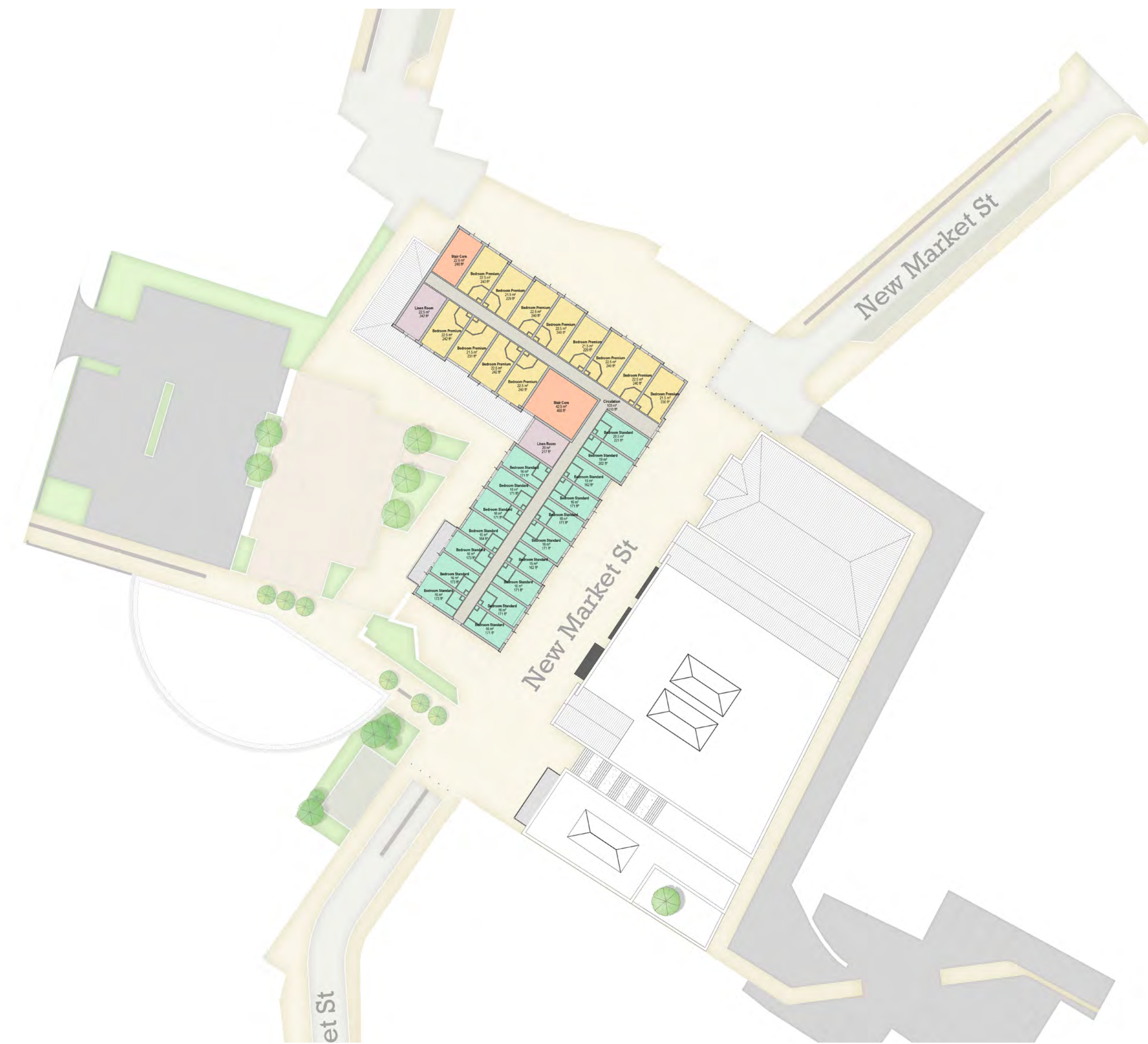

Second Floor Plan



Third Floor Plan



Illustration view to Finished Development



How an Artisan Market on Clitheroe Food Festival Day could use the new space



A view to the new Outdoor Market



Tying the historic town together